

comfy barwon

FROM \$136,520 + GST



SIZE: L 10000mm x W 4000mm
(Other sizes available on request)

STANDARD OPTIONS

- Engineered footings
- Steel base
- Structural timber frame
- Trimdeck colorbond roof
- Aluminium awning windows and sliding door
- Double glazed
- Colorbond corrugated cladding
- Axon smooth vertical fibre cement sheet
- Fully insulated roof, walls and base
- Bathroom shower, toilet, vanity
- Kitchen
- Cavity sliding internal doors
- Bevelled edge skirts and Architraves (Mdf and Pine)
- Gyprock plaster with square set cornices
- Hybrid floorboards
- Internal and external painting
- Construction Compliance Permit included

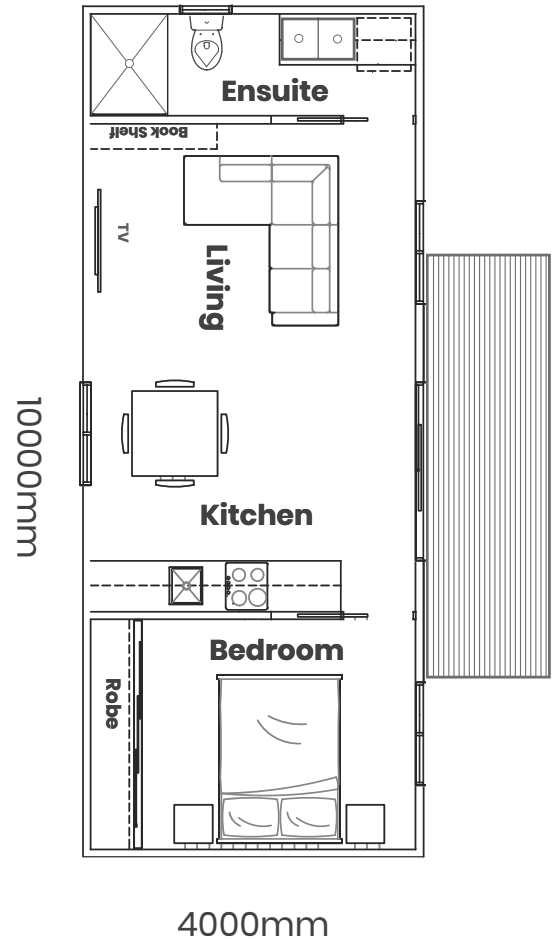

* Standard Unit price. All prices quoted are exclusive of GST and exclude external consultants, permit fees, delivery to site and site works. ComfyPod reserve the right to make modifications to the plans, specifications, and dimensions if so required.